

# NB SERIES DIESEL ENGINE BELT DRIVEN PUMP

## PRODUCT ADVANTAGES

- It adopts excellent hydraulic model design, with large flow and high head;
- It is widely applicable to a variety of working environments and power sources;
- Compact structure, easy for maintenance and installation;
- Multiple ways of coupling, to meet different demands.

## APPLICATION

- Agricultural irrigation, garden sprinkling, water drawn from ponds, breeding water supply and drainage, drought and drainage and fire-fighting.

## SPCIFICATION

- Delivery: up to 90m<sup>3</sup>/h;
- Head: up to 58m;
- Altitude: ≤1000m;
- Pumped liquid temperature: 0 ~ 40°C;
- Pumped liquid PH: 6.5 ~ 8.5;
- Solid content of pumped liquid on volume: ≤0.1% .

## CONSTRUCTION&CHARACTERISTICS

- Compact structure, small size, easy to move and install;
- A variety of power sources to select, power transmitted via the pulley;
- Double bearing to support shaft, ensures steady running;
- Italian mechanical seal, resistant to wear, long service life;
- Cast iron pump casing, durable.

## IDENTIFICATION CODE

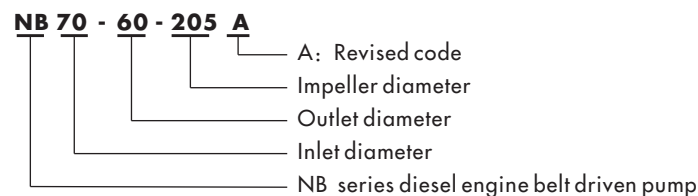

**NB SERIES DIESEL ENGINE BELT DRIVEN PUMP**

## EXAMPLE OF PUMP TYPE: NB70-60-205A

NB series pump, Inlet diameter  $\Phi$ 70mm, Outlet diameter  $\Phi$ 60mm, impeller diameter  $\Phi$ 205mm.

## PUMP SECTION AND LIST OF MAIN COMPONENTS

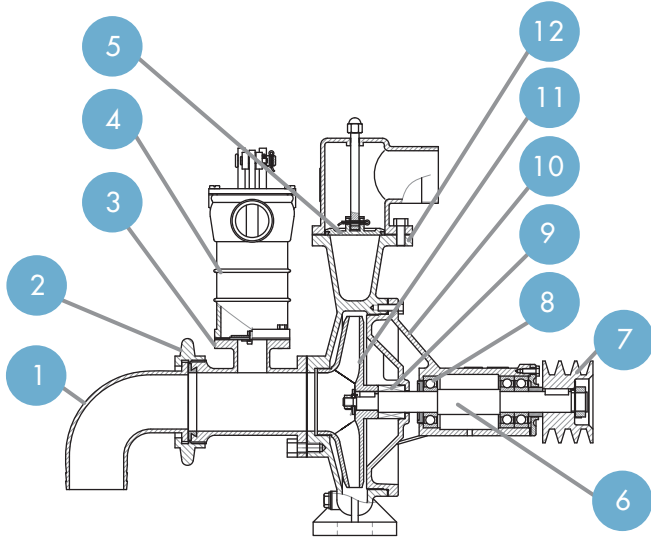

REF.N.	PART	MATERIAL	STANDARD
1	Elbow inlet	Cast iron	ASTM20
2	Adapter	Cast iron	ASTM20
3	Inlet tee	Cast iron	ASTM20
4	Manual exhaust pump	----	----
5	Outlet valve	----	----
6	Shaft	Carbon steel	ASTM1450
7	Pulley	Cast iron	ASTM20
8	Bearing	----	----
9	Mechanical seal	----	----
10	Pump body	Cast iron	ASTM20
11	Impeller	Cast iron	ASTM20
12	Pump volute casing	Cast iron	ASTM20

## DIMENSIONS AND WEIGHTS

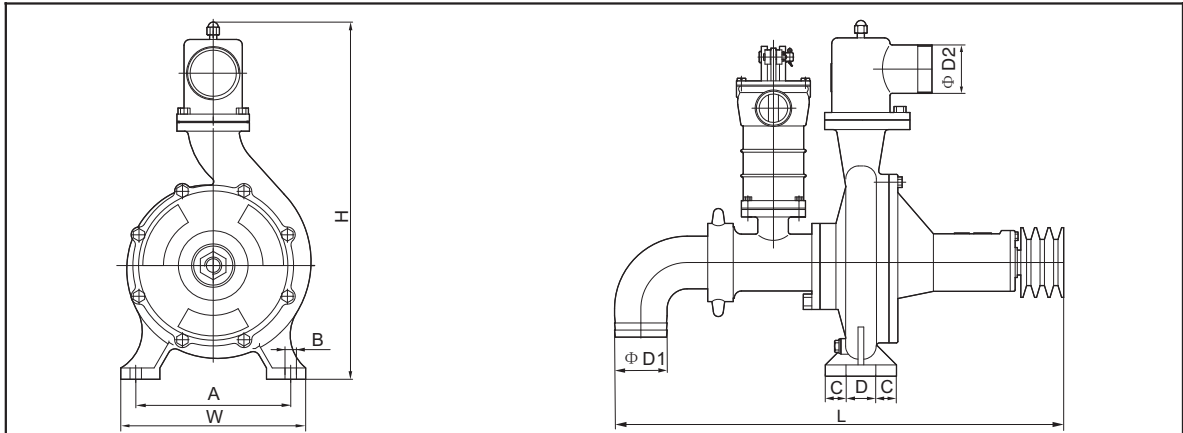

MODEL	L (mm)	W (mm)	H (mm)	A (mm)	ΦB (mm)	C (mm)	D (mm)	ΦD1 (mm)	ΦD2
NHW70-8A	661	205	449	165	12,5	17,5	60	102	102.5mm
NB50-32-160A	613	205	434	165	12,5	17,5	60	64	G1½"
NB65-65-120A	638	205	424	165	12,5	17,5	60	76,5	G1½"
NB70-60-205	632	260	500	218	12,5	12	76	76,5	G2"
NB70-60-205A	632	260	521	218	12,5	12	76	76,5	G2½"
NB60-60-230	652	260	551	200	12,5	20	80	76,5	G3"
NB60-60-230A	652	260	551	200	12,5	20	80	76,5	G2½"

## OPERATING CHARACTERISTICS AT 2900RPM

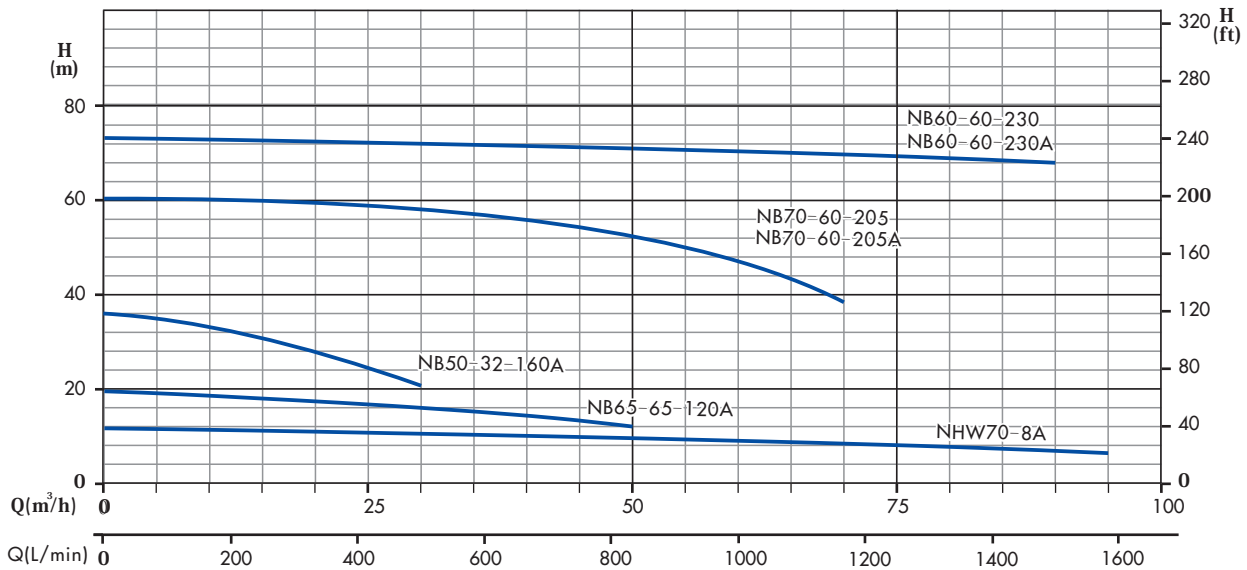

## OPERATING CHARACTERISTICS AT 2900RPM

REF.N.	MODEL	POWER kW	WEIGHT kg	Q=DELIVERY											
				l/min 0	166.6	333.3	500	666.6	833.3	1000	1166.6	1333.3	1500		
				m³/h 0	10	20	30	40	50	60	70	80	90		
H=TOTAL HEAD METERS COLUMN OF WATER															
1	NHW70-8A	3	31,5	12	11,5	11	10,5	10	9	8,5	8	7,5	7		
2	NB50-32-160A	3	27	36	33	28	21								
3	NB65-65-120A	3	27,5	19	19	17,5	16	14	12						
4	NB70-60-205	11	35	60,5	60	59,5	58	56	52	47	39				
5	NB70-60-205A	11	35	60,5	60	59,5	58	56	52	47	39				
6	NB60-60-230	22	40,2	73,5	73	72,5	72	71,5	71	70,5	70	69	64		
7	NB60-60-230A	22	40,2	73,5	73	72,5	72	71,5	71	70,5	70	69	64		

## OPERATING CHARACTERISTICS AT 2900RPM

MODEL	NHW70-8A	NB50-32-160A	NB65-65-120A	NB70-60-205	NB60-60-230
				NB70-60-205A	NB60-60-230A
Q=(m³/h)	70	12,5	35	55	70
H=(m)	8	32	15	50	70
r/min	2900	2900	2900	2900	2900
kW	≥3	≥3	≥3	≥11	≥22
NPSH (m)	≤4,5	≤2,5	≤2,5	≤2,5	≤6
WORKING RANGE	Q (m³/h)	50-85	8,5-20	24-45	38,5-66
	H (m)	9,5-6	35-23	17-10	62-45

**PRODUCT SKETCH**

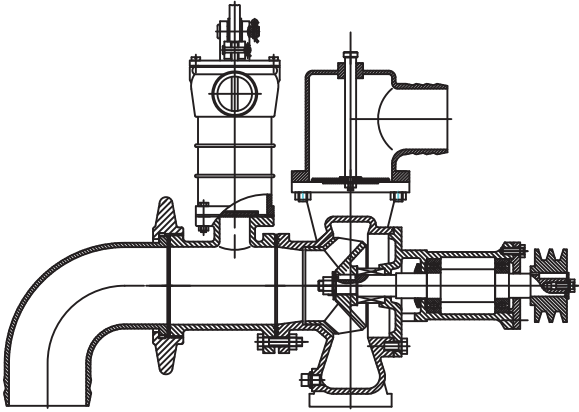

NHW70-8A

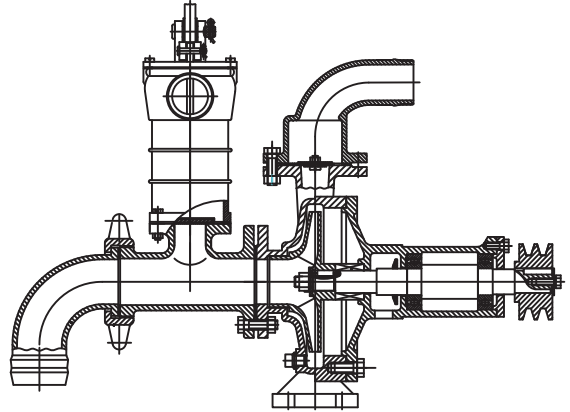

NB50-32-160A

NB60-60-230  
NB60-60-230A  
NB70-60-205A

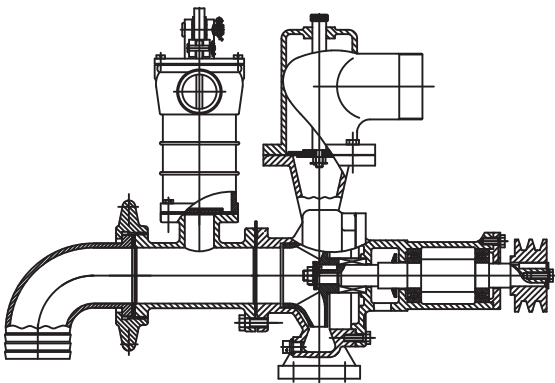
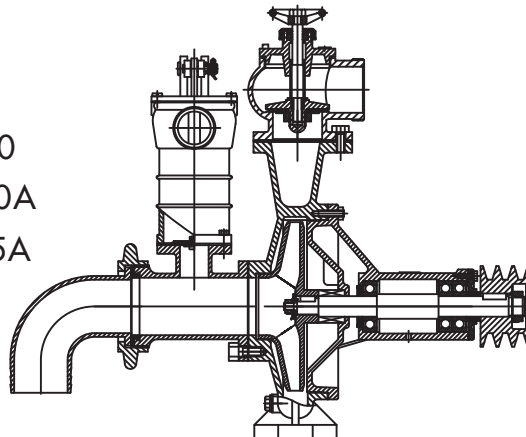

NB65-65-120A

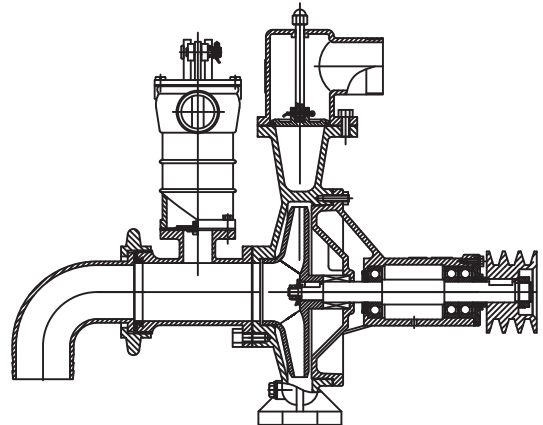

NB70-60-205