

opk SUBMARINE S

SO FLEXIBEL, DER FINDET ÜBERALL SEINEN PLATZ.
SO FLEXIBLE, IT WILL FIND ITS PLACE EVERYWHERE.
TELEMENT FLEXIBLE QU'IL TROUVERA SA PLACE PARTOUT.

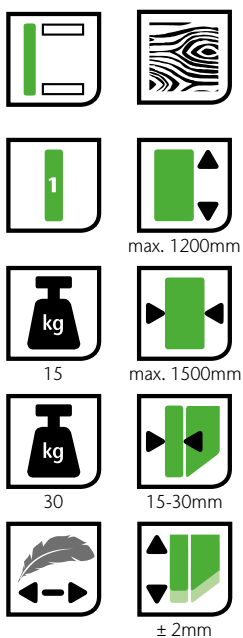

opk Submarine S



Technische Zeichnung Technical drawing / Plans et schémas

Regalboden 18/19/25mm

Cabinet Panel 18/19/25mm / Tablette 18/19/25mm

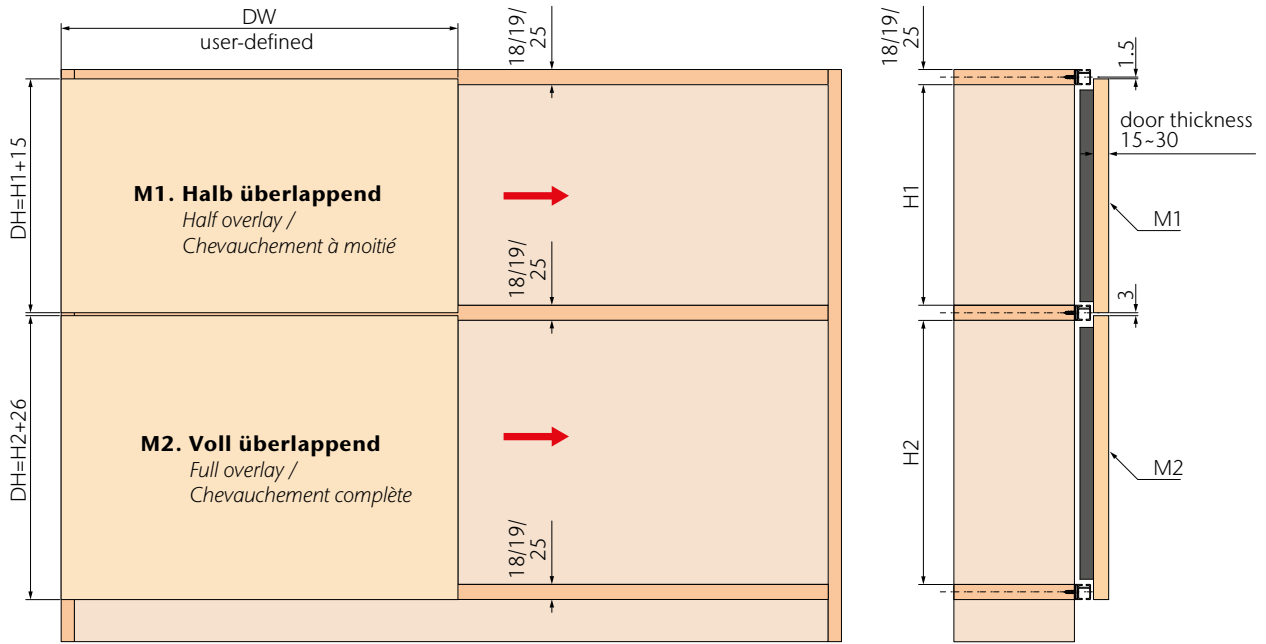

M1. Halb überlappend / Half overlay / Chevauchement à moitié

18/19mm | 18/19mm / 18/19mm

25mm | 25mm / 25mm

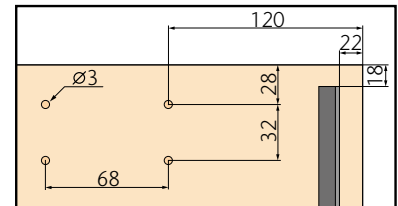
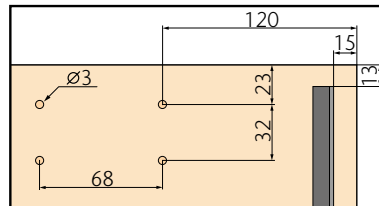

M2. Voll überlappend / Full overlay / Chevauchement complète

18/19mm | 18/19mm / 18/19mm

25mm | 25mm / 25mm

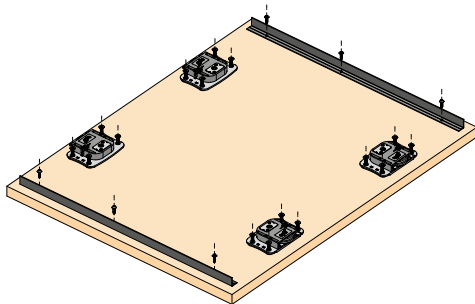
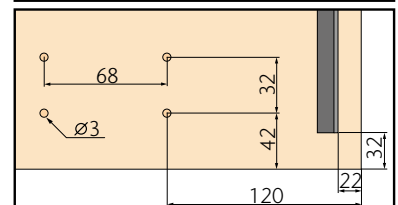
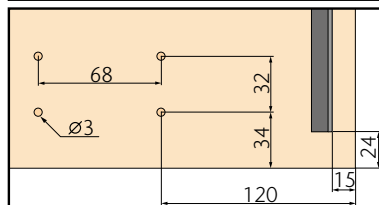
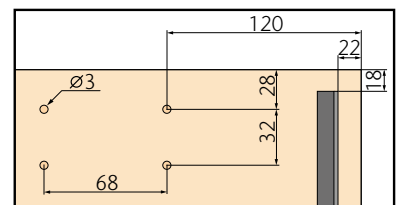
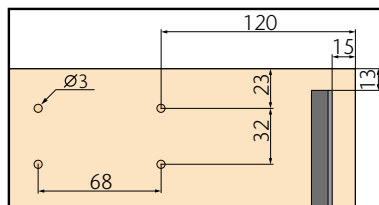

opk Submarine S



Regalboden
Cabinet Panel/
Tablette



Art.-Nr./No./N° d'art.

		18/19mm	≤15	500~1500	≤1200	01-451-002-400
			≤30			01-451-002-430
		25mm	≤15			01-451-002-500
			≤30			01-451-002-530

Konfiguration für 1 Tür

Configuration for 1 door /

Configuration pour 1 porte

18/19mm Regalboden
18/19mm Cabinet Panel/
18/19mm Tablette

25mm Regalboden
25mm Cabinet Panel/
25mm Tablette



	18/19mm Regalboden 18/19mm Cabinet Panel/ 18/19mm Tablette	25mm Regalboden 25mm Cabinet Panel/ 25mm Tablette	
Laufwerk/Führung <i>Running/Guiding part / Train de roulement/guidage</i>			4
Dämpfer <i>Damper / Amortisseur</i>			2
Distanzhalter <i>Distance holder / Entretoise</i>			8
Stopper <i>Stopper 18mm/ Butée</i>			4
Schienenbefestigungsplatte <i>Track connection / Plaque de fixation de rail</i>			16
Schienenabdeckkappe <i>Track plug / Cache de rail</i>			4
Bohrmuster <i>Drilling pattern / Gabarit de perçage</i>			1
ST4.2x16 Senkkopfschraube mit Kreuzschlitz <i>ST4.2x16 Cross recess countersunk head self-drilling screw / ST4.2x16 Vis fraisée à tête cruciforme</i>			64
SW 2mm Innensechskant <i>SW 2mm hex key / SW 2mm Six pans creux</i>			1

opk Submarine S



Schienen, Zubehör

Tracks, Accessories / Rails, Accessoires

Produktbeschreibung <i>Product description / Description du produit</i>		Material <i>Material / Matériel</i>	Farbe <i>Finish / Couleur</i>	Länge (mm) <i>Length / Longueur</i>	Art.-Nr./No./ N° d'art.
Laufschiene 18/19mm Regalboden <i>Running track 18/19mm / Rail de roulement 18/19mm Tablette</i>		Aluminium eloxiert <i>Anodized aluminium Aluminium anodisé</i>	Silber <i>Silver Argent</i>	2500	01-456-250-425
				3500	01-456-250-435
				5800	01-456-250-458
Laufschiene 25mm Regalboden <i>Running track 25mm / Rail de roulement 25mm Tablette</i>		Aluminium eloxiert <i>Anodized aluminium Aluminium anodisé</i>	Silber <i>Silver Argent</i>	2500	01-456-250-525
				3500	01-456-250-535
				5800	01-456-250-558
Blende <i>Decorative profile/ Profil décoratif</i>		Aluminium eloxiert <i>Anodized aluminium Aluminium anodisé</i>	Silber <i>Silver Argent</i>	2500	01-458-250-025